

# DCP 21 REAR SERVICE ACCESS RIVER ROAD RESERVE PACIFIC HIGHWAY, WYONG

This plan shall be known as:

REAR SERVICE ACCESS - RIVER ROAD RESERVE  
PACIFIC HIGHWAY, WYONG

DEVELOPMENT CONTROL PLAN NO 21

## OBJECTIVES

This Development Control Plan aims to achieve the following:

To provide for a rear service access to those properties situated between the River Road reserve and the Pacific Highway, Wyong.

To provide for the orderly and economic development of the land to which it applies.

This Development Control Plan (DCP) may be amended from time to time by Council. Proposed amendments are required to be advertised and exhibited in draft form and any submissions received must be considered by Council before the amended plan is adopted. People using this DCP should ensure that they have the current copy of the plan, including any amendments. If in doubt, please check with Council's Customer Service Centre.

ADOPTED AS PER COUNCIL RESOLUTION NO.  
EFFECTIVE: 25 August 1988  
CERTIFIED IN ACCORDANCE WITH THE  
ENVIRONMENTAL PLANNING AND  
ASSESSMENT ACT 1979 AND REGULATIONS

  
GENERAL MANAGER  
DATE: \_\_\_\_\_

The Development Control Plan has been prepared pursuant to Section 72 of the Environmental Planning and Assessment Act, 1979 and Clause 24 of the Environmental Planning and Assessment Act Regulations dated August 29 1980.

Land to which the plan applies:

Lot Pt 12 DP 3136  
Lot 100 DP 732014  
Lot B DP 308296

### **IMPLEMENTATION**

In determining applications for the development of land to which this plan applies, Council will require:

- a The transfer in fee simple to Council of part of the land required for the rear service laneway at no cost to Council, in accordance with Council's Plan No 6548.
- b The construction of the rear service lane to bitumen sealed standard, 3.5 metres width in accordance with Council's design and construction standards.

### **SAVINGS PROVISION**

Any Person making an application for the development of properties affected by this plan should have due regard to the provisions of the Wyong Local Environmental Plan 1987 - Urban Lands and any other development codes as are adopted by Council at the time of application.

Council reserves the right to vary the plan to a minor extent having regard to the physical constraints of any given site or any improvements erected thereon.

Figure 1: Locality Plan

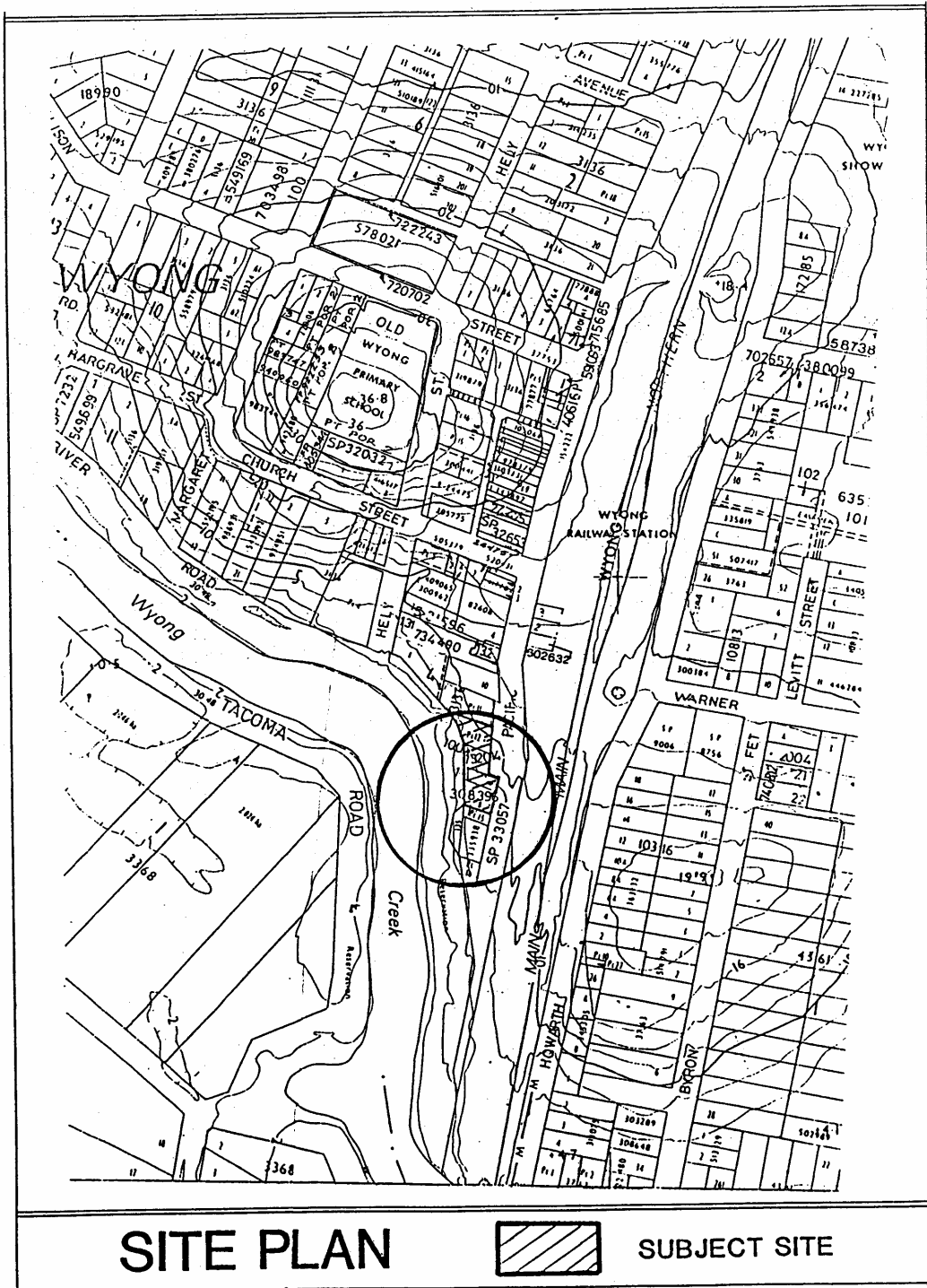

Rear Service Access – River Road Reserve, Pacific Highway, Wyong  
Development Control Plan No 21

Figure 2: Lot A and B FP 308396, Part Lot 13 DP 3136  
Pacific Highway, Wyong - Proposed Rear Laneway

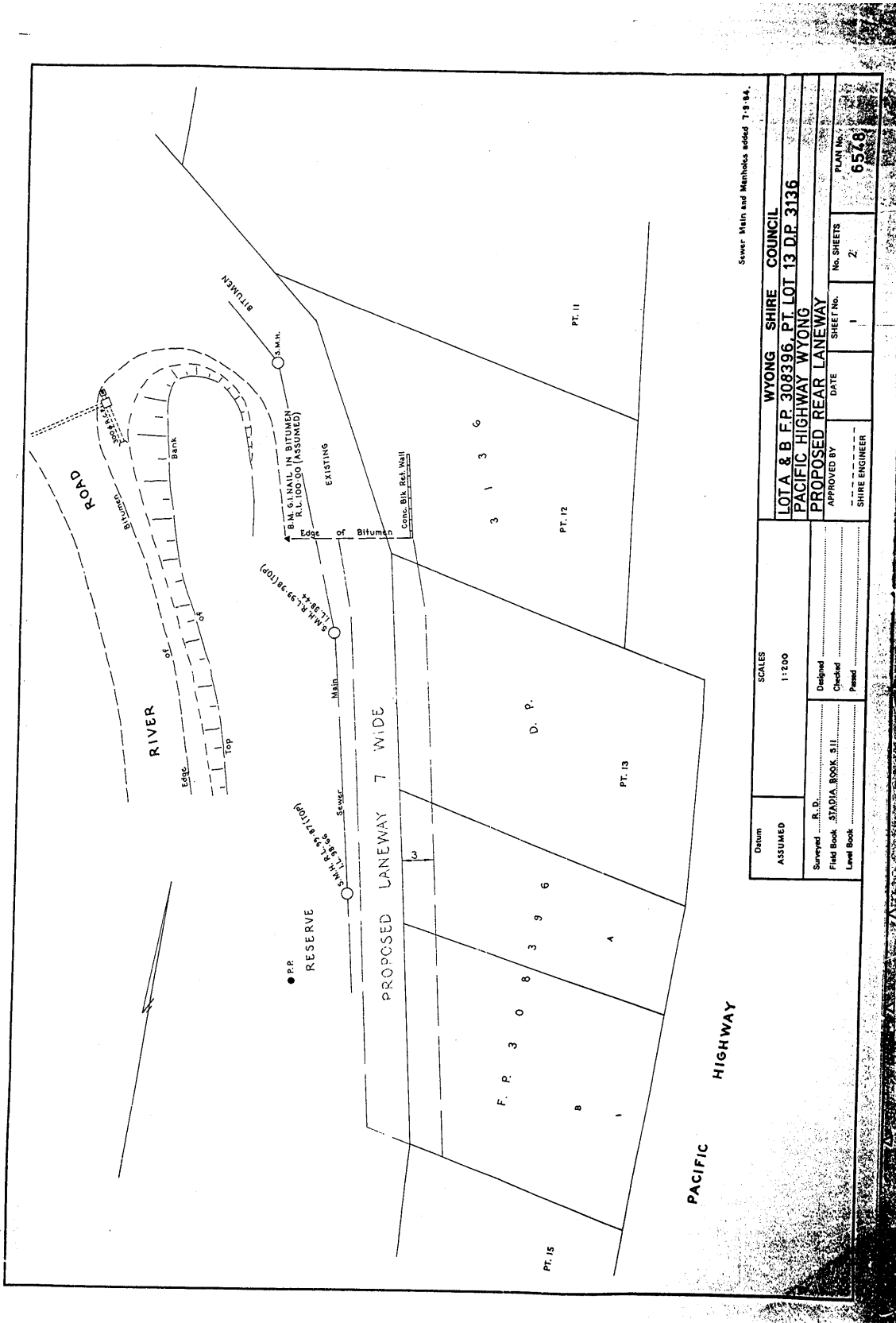

Rear Service Access - River Road Reserve, Pacific Highway, Wyong  
Development Control Plan No 21